

Machine Screws

Head Dimensions

Pan
Combo Pan

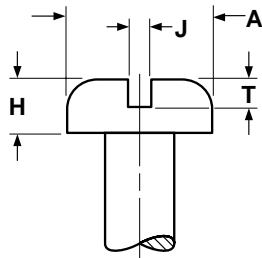

Slotted

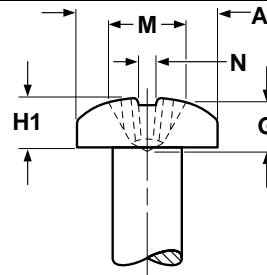

Phillips

PAN HEADS FOR MACHINE SCREWS AND SEMS

ANSI B18.6.3

Nominal Size	A		H		H1		J		T		M		G	N	Phillips Driver Size
	Head Diameter		Height of Head				Width of Slot		Depth of Slot		Dimensions of Recess				
			Slotted		Recessed						Diameter		Depth	Width	
	Max	Min	Max	Min	Max	Min	Max	Min	Max	Min	Max	Min	Max	Min	
0	.116	.104	.039	.031	.044	.036	.023	.016	.022	.014	.067	.054	.039	.013	0
2	.167	.155	.053	.045	.062	.053	.031	.023	.031	.022	.104	.091	.059	.017	1
3	.193	.180	.060	.051	.071	.062	.035	.027	.036	.026	.112	.099	.068	.019	1
4	.219	.205	.068	.058	.080	.070	.039	.031	.040	.030	.122	.109	.078	.019	1
5	.245	.231	.075	.065	.089	.079	.043	.035	.045	.034	.158	.145	.083	.028	2
6	.270	.256	.082	.072	.097	.087	.048	.039	.050	.037	.166	.153	.091	.028	2
8	.322	.306	.096	.085	.115	.105	.054	.045	.058	.045	.182	.169	.108	.030	2
10	.373	.357	.110	.099	.133	.122	.060	.050	.068	.053	.199	.186	.124	.031	2
12	.425	.407	.125	.112	.151	.139	.067	.056	.077	.061	.259	.246	.141	.034	3
1/4	.492	.473	.144	.130	.175	.162	.075	.064	.087	.070	.281	.268	.161	.036	3
5/16	.615	.594	.178	.162	.218	.203	.084	.072	.106	.085	.350	.337	.193	.059	4
3/8	.740	.716	.212	.195	.261	.244	.094	.081	.124	.100	.389	.376	.233	.065	4

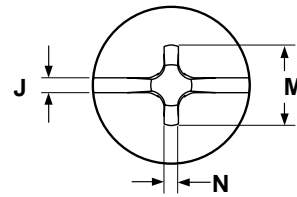
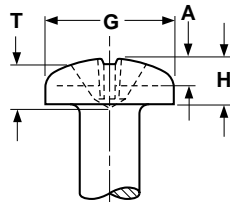

COMBINATION DRIVE PAN HEADS FOR MACHINE SCREWS

Nominal Screw Size	G		H		J		A		M		T		N		Recess Penetration		Driver Size
	Head Dimensions				Slot Dimensions				Recess Dimensions								
	Head Diameter		Head Height		Width		Depth		Diameter		Depth		Recess Width				
	Max	Min	Max	Min	Max	Min	Max	Min	Max	Min	Max	Min	Min	Max	Min		
4	.219	.205	.080	.070	.039	.031	.040	.030	.122	.109	.078	.060	.019	.071	.053	1	
6	.270	.256	.097	.087	.048	.039	.050	.037	.166	.153	.091	.066	.028	.080	.055	2	
8	.322	.306	.115	.105	.054	.045	.058	.045	.182	.169	.108	.082	.030	.097	.071	2	
10	.373	.357	.133	.122	.060	.050	.068	.053	.199	.186	.124	.100	.031	.113	.089	2	
12	.425	.407	.125	.112	.067	.056	.077	.061	.259	.246	.141	.115	.034	.124	.098	3	
1/4	.492	.473	.175	.162	.075	.064	.087	.070	.281	.268	.161	.135	.036	.144	.118	3	
5/16	.615	.594	.218	.203	.084	.072	.106	.085	.350	.337	.193	.169	.059	.173	.149	4	